



BG750
USER MANUAL
Robotic Vacuum Cleaner

Please keep this user manual close for future reference
Read it carefully before using this product

Table of Contents

1. Important Safety Instructions

1.1 Safety Advice and Warnings.....	2
1.2 Battery and Charging/ Information.....	4

2. About Your Robot

2.1 Main Body.....	5
2.2 Accessories	6
2.3 Dust bin and Suction Inlet.....	6
2.4 Charging Base.....	7
2.5 Remote Control.....	7
2.6 LED Indicators.....	8

3 .Using Your Robot

3.1 Important Tips Before Use.....	8
3.2 Preparation.....	9
3.3 Charge Your Robot.....	10
3.4 Use Your Robot with the Bagotte App	11
3.5 Start/Stop Cleaning.....	13
3.6 Cleaning Mode.....	14
3.7 Set Time and Scheduled Cleaning.....	15
3.8 Use the Boundary Strip.....	16
3.9 Use Your Robot with Amazon Alexa/ the Google Assistant.....	17

4. Regular Robot Care

4.1 Emptying Robot's Bin.....	19
4.2 Cleaning Robot's Filter.....	20
4.3 Cleaning Robot's Rolling Brush, Side Brush,Swivel Wheel.....	20
4.4 Cleaning the Sensors and Charging Pins.....	21

5. Troubleshooting

5.1 Error Tones.....	22
5.2 Frequently Asked Questions.....	23
5.3 Wi-Fi Connection.....	25

6. Specifications

6. Specifications.....	26
------------------------	----

7. FCC Statement

7. FCC Statement.....	27
-----------------------	----

1 Important Safety Instructions



BG750 Robot Vacuum Cleaner

Dear Customer,

We are deeply honored that you chose our products and would like to thank you for your purchase. Our products includes the latest technology in the market, allowing our products to offer you Efficiency, Easy Operation and Long Lasting Service when you use it. Also we made sure the design of our products is cool and the maintenance easy to make your life way simpler. Read these instructions carefully before using our robot vacuum cleaner and keep this manual for further reference. Failure to follow these instructions could lead to product failure or harm.

1.1 Safety Advice and Warnings

- This device is not intended for use by people (including children) with reduced physical, sensory or mental capacities, or people without experience or knowledge, unless they have benefited from surveillance or prior instructions regarding the use of the device by a person responsible for their safety.
- Cleaning and maintenance shall not be performed by children without adult supervision.
- This appliance is not a toy. Children should be supervised to ensure that they do not play with the appliance.
- This appliance contains accessories with rotary parts. Loose clothes, jewellery or long hair can be caught in moving parts. Dress properly. Do not wear baggy or loose hanging clothes or accessories. Keep your hair, clothing and gloves away from moving parts.
- This product is designed to be plugged into a standard outlet only. Product may not be used with any type of power converter. Use of power converters will immediately void the warranty.
- **CAUTION:** Only use Bagotte Max 14.4V Max 2600mAh Ni-MH or Max 2600mAh Li-ion Battery. Other type of batteries might cause bursting and therefore injuries. Always contact Bagotte Customer Service to receive the best advice and the best service event for the replacement of your battery.
- Always charge and remove the battery from your robot and accessories before long-term storage or transportation.
- The battery must be removed from this device before this device is disposed. To remove the battery from this device, first remove the screws on the bottom, then remove the main PCB and unscrew the battery cover using a screwdriver. Remove the battery by disconnecting the quick connector.

-  **WARNING Chemical Exposure:** If the battery pack is leaking, do not let the liquid to come in contact with skin or eyes. If the liquid reached the skin or the eyes, wash the area with loads of water and contact your medical adviser. Place the battery (the used battery pack included when the robot will be disposed) in a sealed plastic bag and dispose of safely according to local environmental regulation.
-  **WARNING Fire or Explosion Hazard:** Do not crush or dismantle battery packs. Do not heat or place the battery pack near any heat source or direct sunlight. Do not incinerate or short-circuit the battery pack. Do not subject batteries to mechanical shock.
- Contact your local waste management authority for battery recycling and disposal regulations in your area.
- This device is designed for indoor use only, please do not use it outdoor or under strong light environment.
- Do not use non-rechargeable batteries. Use only the rechargeable battery supplied with the product.
- Store and operate the device in room temperature environments only.
- The external flexible cable or cord of the power supply unit cannot be replaced; if the cord is damaged, the power supply unit shall be disposed of.
- Do not use robot to pick up sharp objects, glass, or anything that is burning or smoking.
- Do not immerse the battery pack.
- Do not use this device to pick up spills of water bleach, paint, or other chemicals, or anything wet.
- Before using our robot vacuum cleaner, make sure that the floor is cleared of objects like clothes, papers, curtain strings or power lines. If such objects come in contact with the vacuum cleaner, the central may swallow it and block the robot.
- If the room to be cleaned contains a balcony, a physical barrier should be used to prevent access to the balcony and ensure safe operation.
- Do not place anything on top of this device.
- Be aware that this device moves around on its own. Take care when walking in the area where this device is operating to avoid stepping on it.
- Do not operate this device in areas with exposed electrical outlets on the floor.

- Do not use this device on an unfinished, unsealed, waxed or rough floor. It may result in damage to the floor and this device. Use only on hard floor surfaces or low-pile carpet.
- This device has been designed to be used on floors without scratching them. We still recommend that you test this device on a small area of the room to be cleaned to ensure no scratches are made before cleaning the whole room.

1.2 Battery and Charging/Information

Lithium-ion Battery

Important: Lithium-ion batteries and products that contain Lithium-ion are subject to stringent transportation regulations. If you need to ship this product (with the battery included) for service, travel or any other reason, you **MUST** comply with the following shipping instructions:

- Remove the Lithium-ion battery from the product.
- Place a Piece of tape over the battery's metal charging contacts.
- Reinstall the battery (with the tape on it) in the product and secure the battery door.
- Package the product in its original packaging or in your own packaging that prevents any movement during transportation.
- Ship via ground transportation only (no air shipping).

Battery Storage

If storing robot off the Charging Dock, remove the battery first. Then store the robot and the battery in a cool, dry place.



The symbol on this product or its packaging indicates that this device cannot be disposed as unsorted municipal waste. To dispose of such device, you need to use separate collection facilities. Contact your local authority for information regarding the collection systems available. If electrical appliances are disposed of in landfills or dumps hazardous substances can leak into the groundwater and get into the food Chain, damaging your health and well-being. Please contact your local or regional waste authority for more information on collection, reuse and recycling programs.

2 About Your Robot

2.1 Main Body

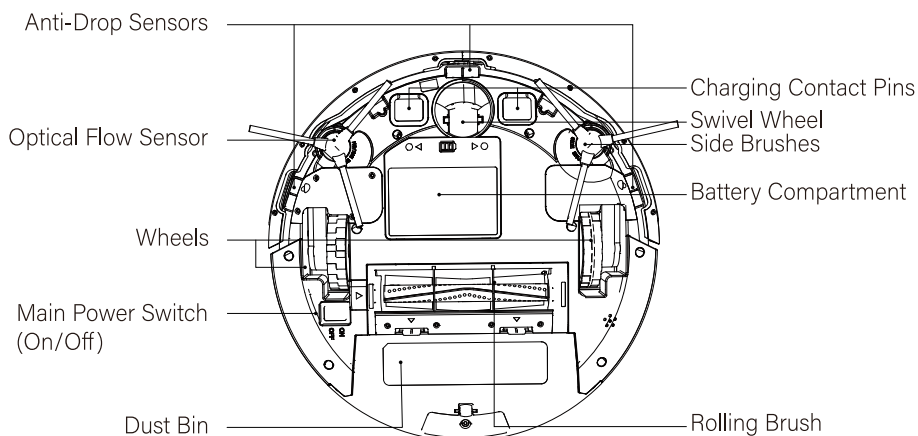
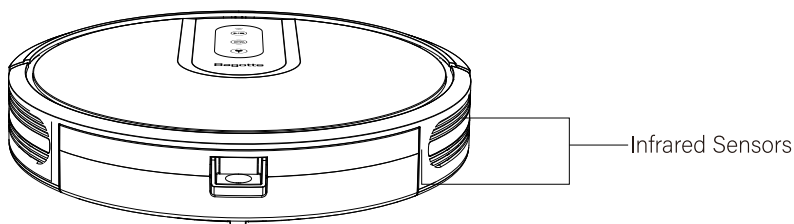
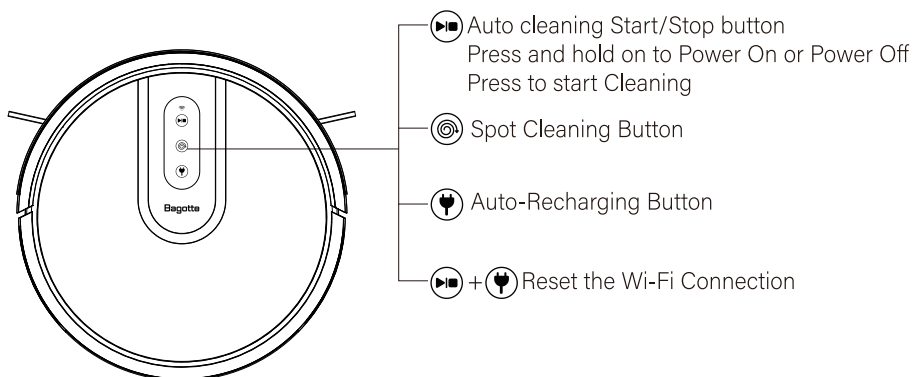

2.2 Accessories

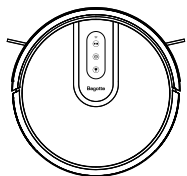

Main unit

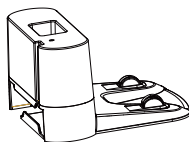

Charging Base

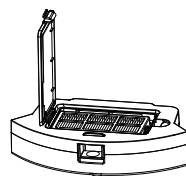

Dust Bin



Water Tank

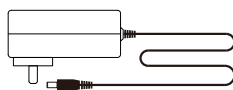

Power Adapter

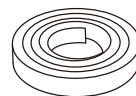

Boundary Strips



4 x Side Brushes

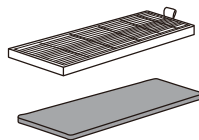

Additional High Performance
Filter And Foam Filter



Remote Control
(AAA Battery x 2)



Cleaning Tool



Mop



Owner's Manual &
Other Documents

2.3 Dust Bin and Suction Inlet

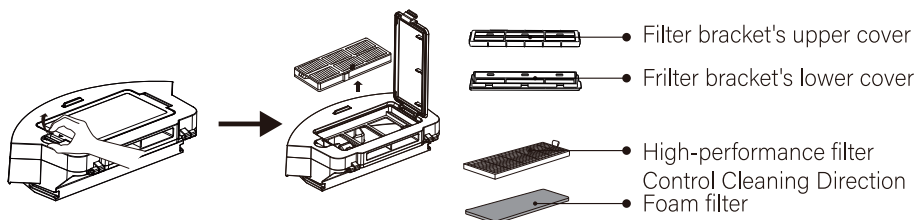

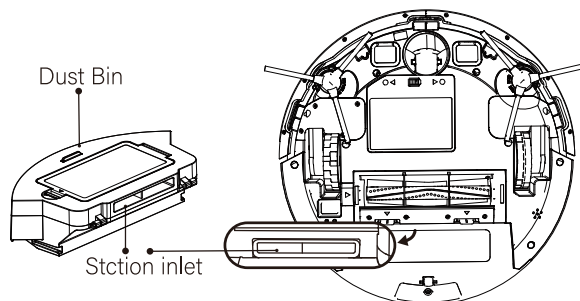

2.4 Charging Base

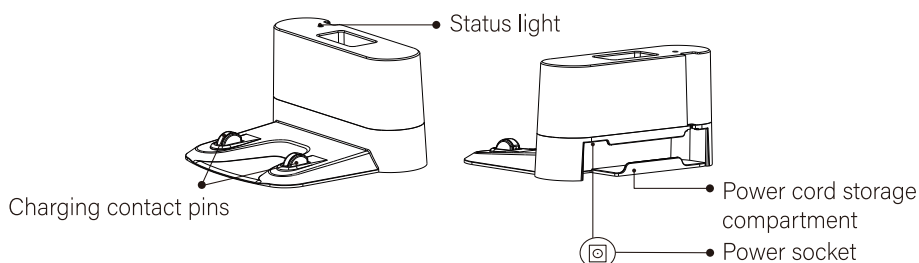

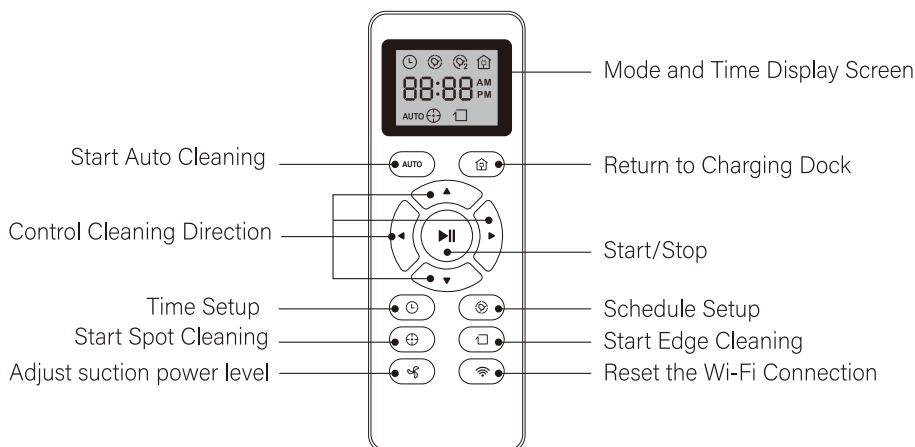

2.5 Remote Control



Install 2 AAA batteries before using the remote control for the first time. Make sure the positive and negative ends are facing the correct polarity direction as marked in the battery compartment.

2.6 LED Indicators

You can see the status of Robot from the LED indicator.

Power Status Light		Status
	Flashing Blue	Charging
	Continuous Blue	Returning to charging Base/Fully Charged/Standby/Cleaning
	Flashing red	Error Indicators
	Continuous Blue	In cleaning/ Complete cleaning
	Flashing red	Error indication (along with voice prompts) Refer to the " Troubleshooting>Voice Alert " section in this manual for solutions.
	Continuous Blue	High power recharging
	Continuous Orange	Low power recharging

3 Using Your Robot

3.1 Important Tips Before Use

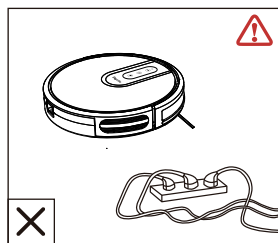

1

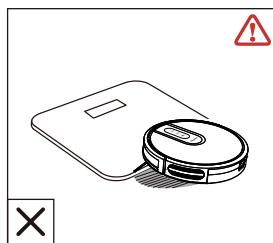

2

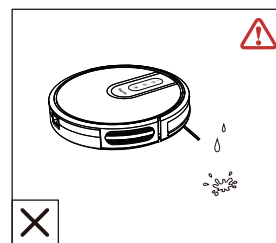

3

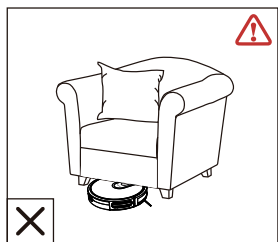

4

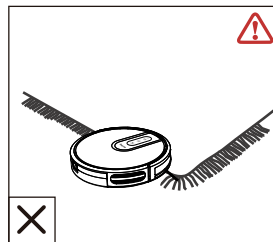

5



6

- ❶ Remove every objects that might entangle the robot such as curtains stings, power cords, nails etc...
- ❷ Robot may climb on top of objects less than 0.59in/15 mm in height. Remove these objects if possible.
- ❸ Keep robot away from wet areas.
- ❹ Keep robot away from spaces lower than 2.83in/72 mm to prevent robot from getting stuck. If necessary, place a physical barrier to block off the problem areas.
- ❺ Fold tasseled edges of area rugs underneath to prevent tangling robot. Avoid cleaning very dark-colored high-pile rugs or rugs thicker than 1.02in/26 mm as they may cause robot to malfunction.
- ❻ Anti-drop sensors prevent robot from tumbling down stairs and steep drops. They may work less effectively if dirty or used on reflective/very dark-colored floors. It is recommended to place physical barriers to block off areas where Robot may fall.



Place physical barriers in from of areas that might damage the robot such as fireplaces, heaters, pools etc...

3.2 Preparation

- ❶ Plug in the Charging Base, and place the remaining lenght of power cord in the compartment at the bottom of Charging Base.

Note: You will hear the corresponding prompt and cancel successfully.

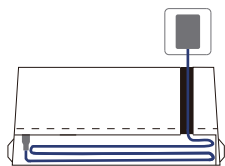

- ❷ Charging Base Position
Place the Charging Base on a hard, level surface and against a wall.

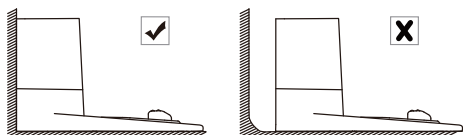

- ❸ Remove objects within 3ft/1m of the left and right side and within 6ft/2m of the front of the charging base.

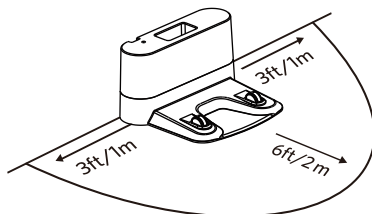

- 4 Connect the round connector of the adapter into the power socket on the Charging Base and the other end into a wall outlet.

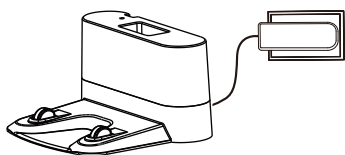

- Install the Charging Base in a location that Robot can easily access. It is recommended to place the Charging Base against a wall, and on a hard-level surface rather than on rugs or carpets.
- Always keep the Charging Base plugged in, otherwise the robot won't be able to automatically find its way back to the charging base.

- 5 Install Side Brushes
Connect side brushes to the bottom of robot by pressing a brush into each slot,

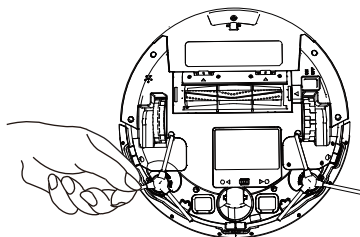

- 6 Turn on the main power switch on the bottom of robot.

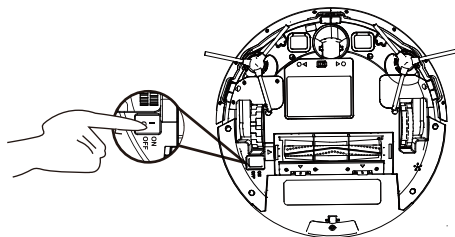



3.3 Charge Your Robot

- Robot has a pre-installed rechargeable battery that has to be fully charged before use.
- Robot returns to the Charging Base at the end of a cleaning cycle or when its battery is running low.

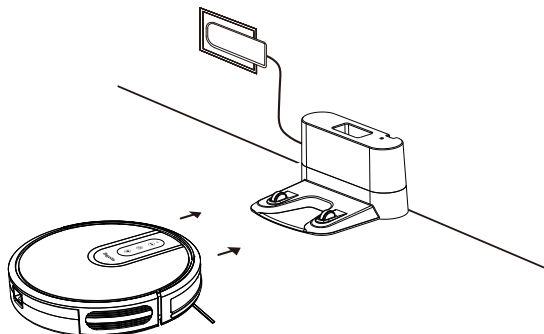
Method 1: Connect the robot to the Charging Base by aligning its charging pins with the charging pins on the base.



Method 2: Press "  " on the remote control or Press "  " on the robot to return robot to the Charging Base.

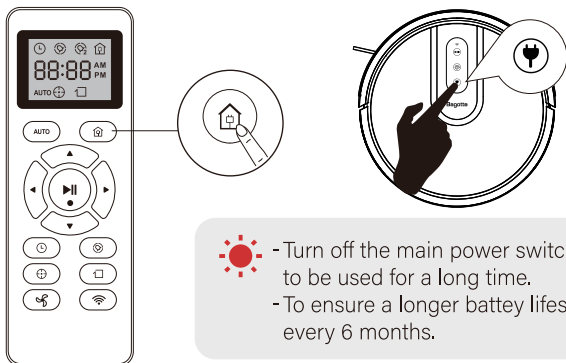

- Turn off the main power switch if the robot is not intended to be used for a long time.
- To ensure a longer battery lifespan, charge it at least once every 6 months.

3.4 Use Your Robot with the Bagotte App

To enjoy all available features, it is recommended to control your robot via the Bagotte App.

Before you start, make sure that:

- Your smartphone or tablet is connected to a Wi-Fi network.
- Your smartphone or tablet is running with iOS 8.0 (or above) or Android 4.4 (or above).
- The 2.4GHz band wireless signal is enabled on your wireless router.
- The Wi-Fi status light on robot is slowly flashing blue.
- Robot is attached to the Charging Base to ensure it has enough power during setup.



1. Download the Bagotte app from the App Store (iOS devices) or Google Play (Android devices).
2. Open the Bagotte app and create a user account.
3. Tap the "+" icon in the top right corner to add your robot to your Bagotte account.

4. Follow the instructions in the app to set up the Wi-Fi connection.

- After connecting successfully, you can control robot via the app.
- With the app, you can select a cleaning mode, set the time, schedule a cleaning, view the system status, receive notifications and access additional features.

Wi-Fi Status Light

	Slowly flashing blue	Waiting for connection
	Rapidly flashing blue	Connecting with your wireless router
	Continuous Blue	Connected to your wireless router



- If you have any problems during the Wi-Fi setup process, refer to the "**Troubleshooting > Wi-Fi connection**" section in this Manual.
- If robot gets stuck in any space, tap "**Find My Robot**" in the app to find the machine. This function is available in the Bagotte app only.

Reset the Wi-Fi Connection

Method 1: Press and hold "▶◀" and "📶" button at the same time on robot for 3 seconds to reset the Wi-Fi connection if necessary.

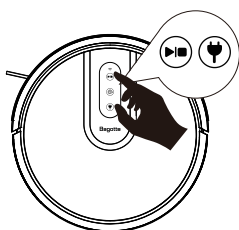

Method 2: Press and hold "📶" on the remote control for 3 seconds to reset the Wi-Fi connection if necessary.

- You will hear a beep when the Wi-Fi connection has been reset and the Wi-Fi status light will slowly flash blue. Now you can follow the Wi-Fi instructions in the Bagotte app to set up the Wi-Fi connection.

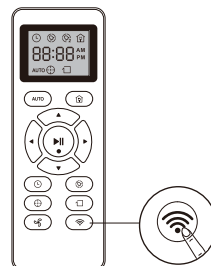

Schedule Cleaning

With the Bagotte App, you can schedule robot to start cleaning at a particular time.



You can set the time and customize the cleaning schedules from Sunday to Saturday on the Bagotte App. This function is available in the app only.

3.5 Start/Stop Cleaning

1 Start Cleaning Cycle

- Press the power button "▶" once to wake up the Robot.
- Press the power button "▶" again to start a cleaning cycle (or press the "AUTO" button on Remote Control).

If its battery gets low before finishing a cleaning cycle, robot will return to the Charging Base to recharge.

If the Charging Base is inaccessible, the robot will not be able to return to the charging base. it will return to its starting location and the cleaning cycle will end, please place the robot manually on Charging Base for charging. (Refer Activate the Robot).

Note: Please refer to section 3.6 for more Cleaning Mode.

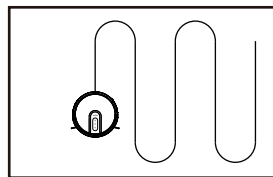
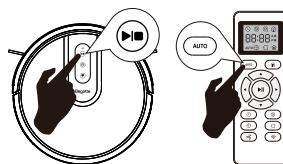

2 Pause

- To suspend a cleaning cycle press the "▶" button or press the "▶" button on Remote Control.
- To resume the cleaning cycle, press "▶" button again.
- To send robot back to The Charging Base, press "🏠" button.

Note: The actions listed above can also be managed from the Remote Control.

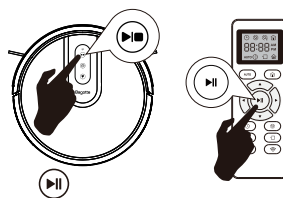

3 Power OFF

- To end the cleaning cycle and put robot in standby mode, press and hold "▶" button until robot indicators turn off.

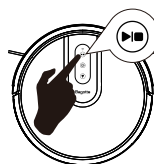

3.6 Cleaning Mode

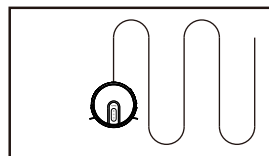
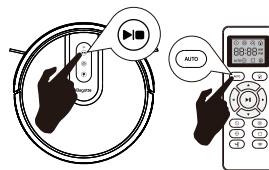

1 Auto Cleaning

- At the start of a cleaning cycle, the robot will map out your home and cleaning it efficiently.
- At various times throughout the cleaning cycle, the robot will bump into every corner of your house, as well as chair legs and other furniture.
- The robot continues this process until it has cleaned the entire house. If its battery gets low before finishing a cleaning cycle, robot will auto return to the Charging Base to recharge.
- Once robot finishes its cleaning cycle, it returns to the Charging Base to recharge.



2 Spot Cleaning

When you select Spot Cleaning, the robot intensely cleans a localized area by spiraling outward about 3 feet(1 meter) in diameter and then spiraling inward to where it started. When the Spot Cleaning Mode is on, the robot boosts its vacuum power to provide the best cleaning possible where you need it.

To use Spot Cleaning, place robot on top of the localized debris and press "  " (Spot) on the Remote Control or press "  " button on the robot.

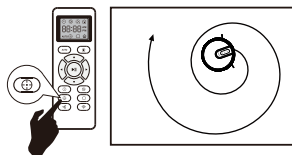

3 Edge Cleaning

After robot finishes cleaning the open areas of your floor, it uses Edge Clean to ensure that it has cleaned along walls and around furniture legs. If you prefer a quicker edge cleaning, press the "  " button on Remote Control.

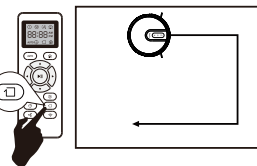

4 Adjust suction Cleaning

In Auto, Spot, Edge Cleaning mode, press "  " on the remote control repeatedly to adjust the suction power level.

Suction power Level	Beeps
Standard power (Default)	•
Strong power	••
Maximum power	•••

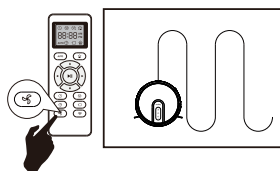

5 Floor Mopping Cleaning

The robot is equipped with a water tank that enables the robot to mop floors.

- Connect the water tank to the tap and fill it with water.
- Remove the dust bin box.
- Put the water tank on the robot and start using it.
- Tank cleaning: turn on the tap and flush the water tank.

Note: If you are using a dry mop to clean, skip the step of filling the water tank.

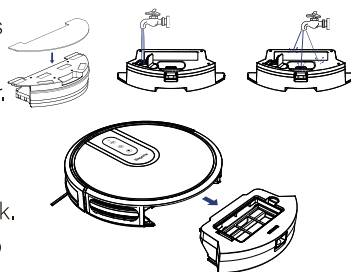

Do not use the floor mopping function on carpets.

After mopping the floor, please empty the water tank in time and remove the mop.

3.7 Set Time and Scheduled Cleaning

Set Time



Make sure the time is set correctly to your local time before setting a scheduled cleaning.

- 1 Make sure the main power switch on the bottom of robot is turned on.
- 2 Press "⏻" on the remote control. The time will blink on the display.
- 3 Press "▲▼▶◀" to set the "hour" and "minute"
Note: Make sure AM/PM is set correctly.
- 4 Press "⏻" or "▶⏸" to save the setting. Robot will **BEEP ONCE** to indicate the time has been set.

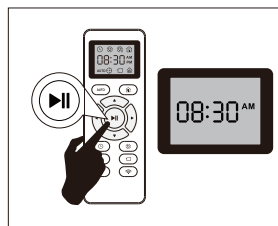
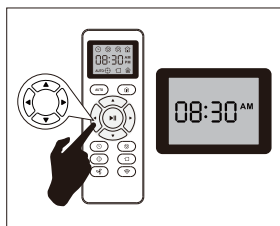
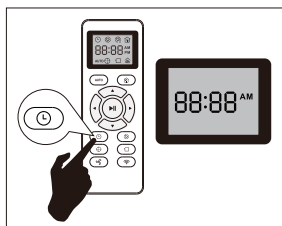
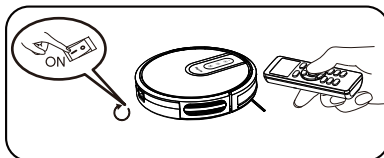

To ensure the time is set successfully, make sure robot is turned on. You will hear a beep when the time has been set.

Set a Scheduled Cleaning

You can schedule robot to start cleaning at a specified time.

Note: Before setting a scheduled cleaning, make sure the time has been set correctly to your local time; refer to the previous section "**Set Time**" for how to set the time.

- 1 Make sure the main power switch on the bottom of robot is turned on.
- 2 Press "⌚" on the remote control "⌚" will blink on the display.
- 3 Press "▲▼▶" to set the "hour" and "minute".
Note: Make sure AM/PM is set correctly.
- 4 Press "⌚" or "▶" to save the setting.

Robot will **BEEP ONCE** to indicate the schedule has been set.

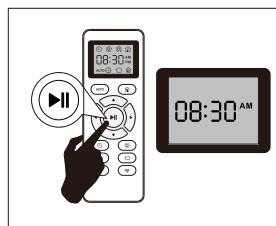
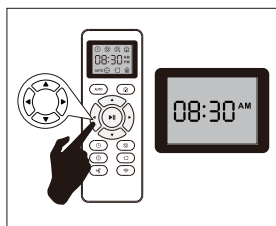
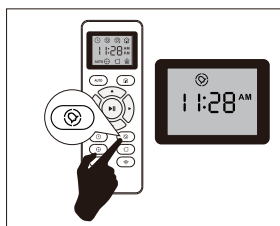
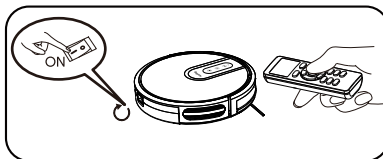

To ensure the time is set successfully, make sure robot is turned on. You will hear a beep when the time has been set.

Cancel the Cleaning Schedule

To cancel a previously scheduled cleaning, press and hold "⌚" for 3 seconds until robot beeps twice and "⌚" on the display will disappear.

3.8 Use the Boundary Strip

With the Boundary Strip, you can keep robot away from any area or item you do not want robot to clean. Robot will recognize the Boundary Strip and will not cross into the blocked-off area.

- 1 Identify the area or item you do not want robot to get close to.
- 2 If necessary, use scissors to cut the Boundary Strip to a shorter length. Make sure to measure correctly the strip length before cutting.

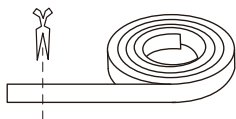

- 3 Apply the supplied strips of adhesive tape to lay the Boundary Strip flat on the floor, Make sure the strip is placed **FLAT** on the floor or under an area rug.

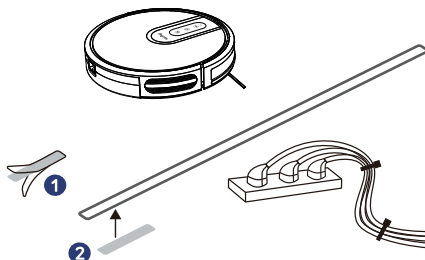

- If the Boundary Strip is rolled up, remove and then re-apply on the floor with adhesive tape. Otherwise the Boundary Strip may not work well.
- Make sure the Boundary Strip is placed on the same surface plane robot is used on.
- Be careful not to damage the floor when using adhesive tape. It is not recommended for use on carpets.
- Keep the Boundary Strip away from objects that emit excessive heat.

3.9 Use Your Robot with Amazon Alexa / the Google Assistant

Amazon Alexa or the Google Assistant is a smart voice control device that enables you to control robot with your voice.

Before you start, make sure that:

- Robot is attached to the Charging Base to ensure there is enough power.
- Robot is connected with the Bagotte app.
- You have an Alexa-enabled device (i.e. Amazon Echo, Echo Dot and Amazon Tap, Echo Show, Echo Spot) or a device enabled with the Google Assistant (i.e. Google Home, Google Home Mini), These devices are sold separately.
- The Amazon Alexa app or Google Home app is already installed on your smart device, and you have created an account.

To control Robot with Amazon Alexa

- 1 Open the Amazon Alexa app and select "Skills & Game" from the "☰" menu.
- 2 On the **Skills** screen, search for " Smart Life".
- 3 Once you have found the "Smart Life" skill, tap **Enable**.

- 4 Login with your Bagotte account so that Alexa can control your robot.
- 5 Say simple commands to Alexa.

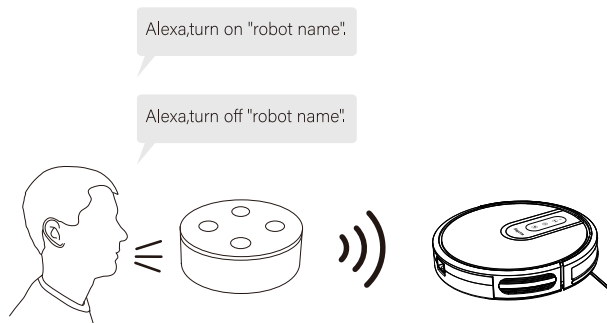

To control robot with the Google Assistant

Robot now works with the Google Assistant on devices like the Google Home.

- 1 Open the Google Home app.
- 2 Say "Ok Google, talk to Robot" to the Google Assistant-enabled device to initiate the Google action for Robot.
- 3 Follow the instructions in the Google Home app to authorize the Google Assistant with your Bagotte App account.
- 4 To control Robot with your voice, say simple commands to Google Assistant.

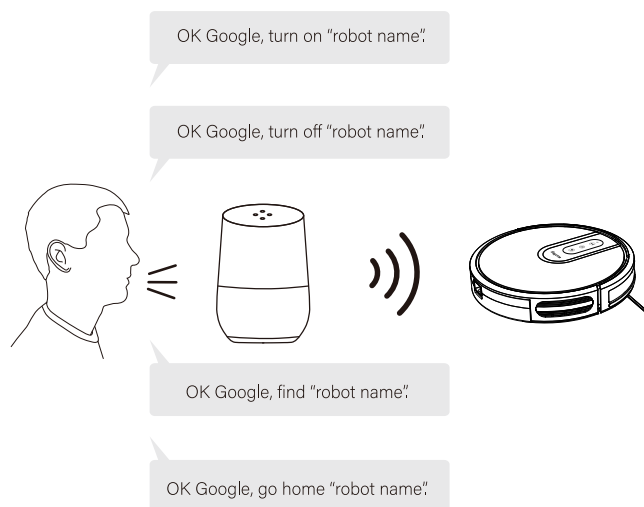

4 Regular Robot Care

To keep robot running at peak performance, perform the following care procedures. If you notice robot picking up less debris from your floor, then empty the bin, clean the filter and rolling brush.

Recommended Cleaning / replacement frequency:

BG750	Cleaning	Replacement Frequency
Dust Bin	After each use	—
Filters	Once every week	Every 2 months
Rolling Brush	Once every week	Every 6-12 months
Side Brushes	Once every month	Every 3-6 months(or when visibly worn)
Sensors	Once every month	—
Charging Pins	Once every month	—
Swivel Wheel	Once every month	—

4.1 Emptying Robot 's Bin

- 1 Press bin release button to remove the bin.
- 2 Open bin's door to empty it.

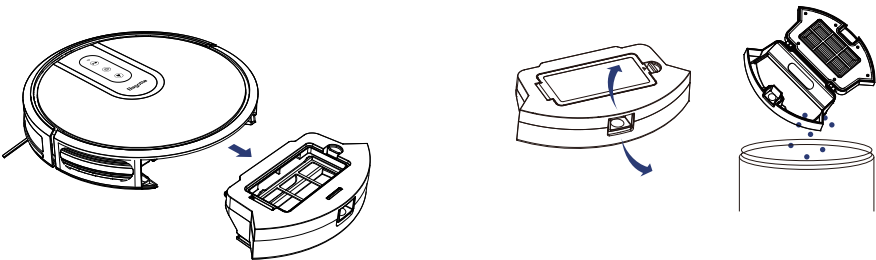

4.2 Cleaning Robot 's Filter

- 1 Remove filter by grasping the white tab.
- 2 Shake off debris by tapping the filter against your trash container.

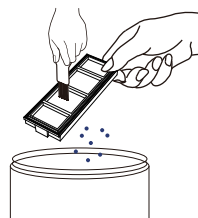
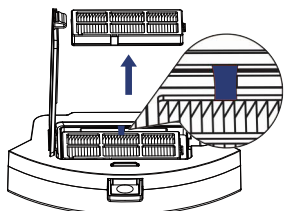

4.3 Cleaning Robot 's Rolling Brush, Side Brush, Swivel Wheel

- 1 Take out the rolling brush, clean the vacuuming aisle by a cloth.

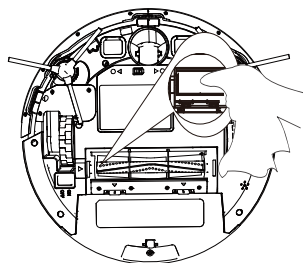
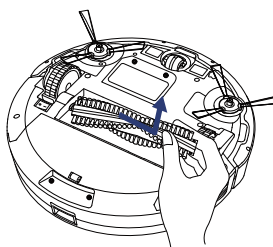
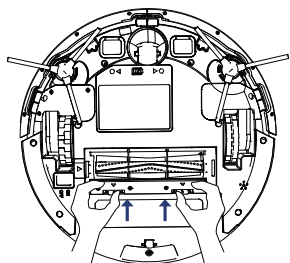

- 2 Clean the rolling brush, Cut down the hair winded in the rolling brush with the provided cleaning tool's knife.
- 3 Remove the side brush, use a cloth to remove the dust from the brush.

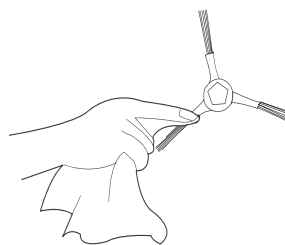
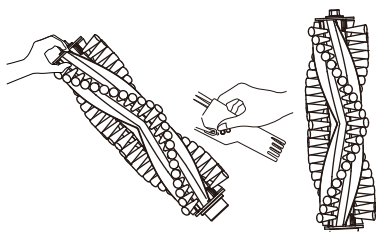

- 4 Pull out the swivel wheel, then clean the Swivel Wheel with the cleaning tool.

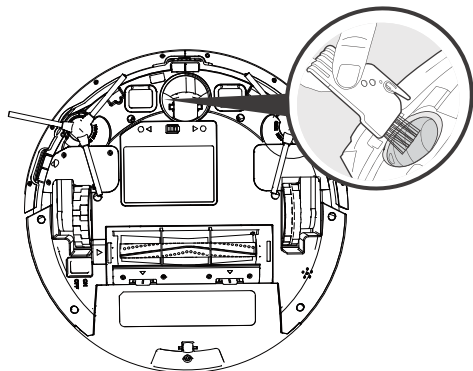

4.4 Clean the Sensors and Charging Pins

To maintain the best performance, clean the drop sensors and charging pins regularly.

- Dust off the drop sensors and charging contact pins using a cloth or cleaning brush.

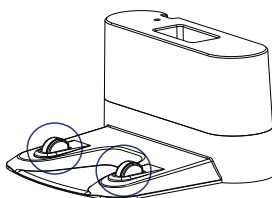
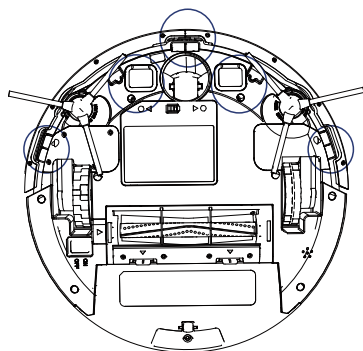

5 Troubleshooting

5.1 Error Tones

When the robot witness any trouble, it will emit a series of short or long beeps and the red indicator on robot will be solid or flashing.

Flashing red indicator light		
Error Tone	Cause	Solution
Two beeps	Robot's bumper is stuck.	<ul style="list-style-type: none"> • Tap robot's bumper several times to dislodge any debris that may be trapped underneath.
Three beeps	Robot's drop sensors are dirty. Robot is stuck on the ledge of a staircase and cannot reverse.	<ul style="list-style-type: none"> • Clean the drop sensors gently with a dry cloth. • Place the robot in a new location. • Use a physical barrier to block off the problem area.
Four beeps	Robot's power level is too low.	<ul style="list-style-type: none"> • Manually charge robot for at least 5 hours.
Solid red indicator light		
Error Tone	Cause	Solution
One beep	Robot's left/right wheel is stuck.	<ul style="list-style-type: none"> • Turn off robot and remove any hair or debris from the left/right wheel.
Two beeps	Robot's side brush is stuck.	<ul style="list-style-type: none"> • Turn off robot and remove any hair or debris debris from the side brush.
Three beeps	Robot's suction fan is stuck.	<ul style="list-style-type: none"> • Turn off robot and remove any hair or debris empty the dust collector. • Make sure the suction inlet is not blocked by any hair or debris.
Four beeps	Robot's rolling brush is stuck.	<ul style="list-style-type: none"> • Turn off robot and remove any hair or debris rom the rolling brush.

5.2 Frequently asked questions

Problems	Solutions
Robot cannot be activated.	<ul style="list-style-type: none"> • Make sure the main power switch is in the ON position. • Make sure the battery is fully charged. • Replace the batteries (2 AAA) in the remote control. • Make sure the remote control is within range (16 ft/5 m) of robot. • If you still have trouble, turn off the main power switch, wait then turn it back on.
The remote control does not work.	<ul style="list-style-type: none"> • Replace the batteries in the remote control. • Make sure Robot is turned on and fully charged.
Robot stops working suddenly.	<ul style="list-style-type: none"> • Check if robot is trapped or stuck on an obstacle. • Check if the battery level is too low. • If you still have trouble, turn off the main power switch, wait for 2 seconds and then turn it back on.
You cannot schedule cleanings.	<ul style="list-style-type: none"> • Make sure the main power switch on the bottom of robot is turned on. • Make sure the time, time of day (AM/PM), and the scheduled time have been set correctly. • Check if robot's power is too low to start cleaning.
Suction power is weak.	<ul style="list-style-type: none"> • Check if any obstructions are blocking the suction inlet. • Empty the dust collector. • Clean the filters with a vacuum cleaner or a cleaning brush. • Check if the filters are wet due to water or other liquid on the floor. Air-dry the filters completely before use.
Robot cannot be charged.	<ul style="list-style-type: none"> • Check if the indicator on the Charging Base lights up. If not, contact the bagotte service center to repair or replace the Charging Base. • Dust off the charging contact pin with a dry cloth. • Check if you can hear a beep when robot is docked onto the Charging Base. If not, contact the bagotte service center to repair or replace the harging Base.

Problems	Solutions
Robot cannot return to the Charging Base.	<ul style="list-style-type: none"> Remove objects within 3 ft/1 m to the left and right side and within 6ft/2 m of the front of the Charging Base. When robot is in the vicinity of the Charging Base, it will return more quickly. However, if the Charging Base is located far away, robot will need more time to return. Please be patient as it works its way back. Clean the charging contact pins.
The rolling brush does not rotate.	<ul style="list-style-type: none"> Clean the rolling brush. Check if the rolling brush and brush guard have been installed properly.
Robot's movements or travel path are abnormal.	<ul style="list-style-type: none"> Clean the sensors carefully with a dry cloth. Restart robot by turning the power switch off and on.
Robot cannot connect to a Wi-Fi network.	<ul style="list-style-type: none"> Make sure your Wi-Fi router supports the 2.4GHz and 802.11b/g/n bands; the 5GHz band is not supported. For details, refer to the "Troubleshooting > Wi-Fi connection" section in this manual.
You cannot control Robot with Amazon Alexa.	<ul style="list-style-type: none"> Check if there are any Internet connection problems. Check whether you have installed the Amazon Alexa app onto your smart device and enabled "Smart Life" Skill in the Amazon Alexa app. For details, refer to the "Use Your Robot with Amazon Alexa/ the Google Assistant" section in this manual. Make sure you have an Bagotte account. Make sure you are using correct Alexa voice-commands.
You cannot control Robot with the Google Assistant.	<ul style="list-style-type: none"> Check if there are any Internet connection problems. Check if you have installed the Google Home app onto your smart device and initiated the "Smart Life" action in the Google Home app. For details, refer to the "Use Your Robot with Amazon Alexa/ the Google Assistant" section in this manual. Check if you are using the proper commands when talking to the Google Assistant. When making your request, first say the wake words "Ok Google". Repeat your question. Speak clearly to the Google Assistant.

5.3 Wi-Fi Connection

Before Wi-Fi setup, make sure robot and your Wi-Fi network meet the following requirements.

Wi-Fi Setup Requirements

Robot:

- Robot is fully charged and the main power switch on the bottom of robot is turned on.
- Wi-Fi status light slowly flashes blue.

Wi-Fi Network:

- Use the correct password for your network.
- Do not use a VPN (Virtual Private Network) or Proxy Server.
- Your Wi-Fi router supports 802.11b/g/n and IPv4 protocol.
- You are using a 2.4GHz router or a dual-band router that is configured to support a 2.4GHz frequency band. Robot does not support 5GHz frequency band.
- If robot cannot connect to the Wi-Fi network and you are using a 2.4/5GHz mixed network, switch to a 2.4GHz network for Wi-Fi setup. You can switch back once your setup is complete.
- When connecting to a hidden network, make sure you enter the correct network name, SSID (case sensitive), and connecting to a 2.4GHz wireless network.
- When using a network extender/repeater, make sure the network name (SSID) and password are the same as your primary network.
- The firewall and port settings of your Wi-Fi router allow robot to connect with the Bagotte servers.

Network Security Requirements

- WPA and WPA2 using TKIP, PSK, AES/CCMP encryption.
- WEP EAP (Enterprise Authentication Protocol) is not supported.

Wi-Fi Channels

- The FCC requires that all wireless devices in the United States operate on the 1-11 wireless spectrum channels.
- Some countries outside North America can use spectrum channels higher than channel 11. Refer to your local regulatory agency to determine which channels are accessible.
- A future software release will support access to channels above 11 for users outside North America. Until then, use channels 1-11.

If you cannot control robot with your smartphone, try the solutions below to solve the problem. If the problem persists, contact the Bagotte service center for help.

Wi-Fi Status Light 	Cause	Solutions
Continuous blue.	Robot has connected to your router, but cannot access the Internet.	<ul style="list-style-type: none"> Check if your router is connected to the Internet. Check with your Internet provider to see if there is any Internet connection problem.
Rapidly flashing blue.	Robot cannot connect to your wireless router.	<ul style="list-style-type: none"> Check if you have modified your network name and password. Reset Wi-Fi connection if necessary. Refer to the "Use Your Robot with the Bagotte App > Reset the Wi-Fi connection" section in this manual.
Slowly flashing blue.	Wi-Fi connection is reset or has not been set up before.	<ul style="list-style-type: none"> Set up Wi-Fi connection with Robot. Refer to the "Use Your robot with the Bagotte App" section in this manual. Reset Wi-Fi connection if necessary. Refer to the "Use Your Robot with the Bagotte App > Reset the Wi-Fi connection" section in this manual.
Off.	Robot is turned off. Robot's power level is low. Robot is in Sleep mode.	<ul style="list-style-type: none"> Charge robot by attaching it to the Charging Base. Make sure the main power switch on the bottom of robot is turned on.

6 Specifications

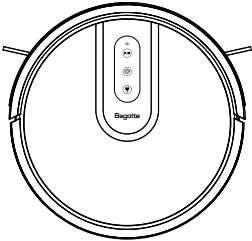
	Product Model	BG750
	Input	19V \approx 0.6A
	Battery VoltageDC	14.4 V
	Power Consumption	28 W
	Battery Type	DC 14.4 V Li-ion 2600 mAh
	Dust Collector Capacity	0.6 L
	Max Cleaning Time	120 mins
	Charging Time	300 - 360 mins

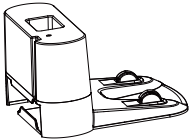
	Input	19 V \approx 0.6 A
	Output	19 V \approx 0.6 A

7 FCC Statement

Changes or modifications not expressly approved by the party responsible for compliance could void the user's authority to operate the equipment.

This equipment has been tested and found to comply with the limits for a Class B digital device, pursuant to Part 15 of the FCC Rules. These limits are designed to provide reasonable protection against harmful interference in a residential installation. This equipment generates uses and can radiate radio frequency energy and, if not installed and used in accordance with the instructions, may cause harmful interference to radio communications. However, there is no guarantee that interference will not occur in a particular installation. If this equipment does cause harmful interference to radio or television reception, which can be determined by turning the equipment off and on, the user is encouraged to try to correct the interference by one or more of the following measures:

- Reorient or relocate the receiving antenna.
- Increase the separation between the equipment and receiver.
- Connect the equipment into an outlet on a circuit different from that to which the receiver is connected.
- Consult the dealer or an experienced radio/TV technician for help.

This device complies with part 15 of the FCC rules. Operation is subject to the following two conditions (1) this device may not cause harmful interference, and (2) this device must accept any interference received, including interference that may cause undesired operation.



CUSTOMER SUPPORT

USA Customer Service: +1-(855)-993-9939 | Mon-Fri 9AM-5PM (PST)

EU Customer Service: +44 20 3966 0097 | Mon-Fri 9AM-5PM(GMT)

Email: support@bagotte.com



@BagotteOfficial



@BagotteOfficial

Get more tips: [bagottelife.com/pages/blog](https://www.bagottelife.com/pages/blog)

DOC

Learn more about the EU Declaration of Conformity, Please click below link to download:

<https://www.bagotte.com/upload/admin/20201104/BG750-DOC-EN.pdf>

Erfahren Sie mehr über die EU-Konformitätserklärung, Klicken Sie zum Herunterladen auf den folgenden Link:

<https://www.bagotte.com/upload/admin/20201104/BG750-DOC-DE.pdf>



Made in China